

Standardowe koła do pasów metrycznych zębatych typu HTD

Podziałka 3 mm ...3 M 09

Kod	Ilość zębów	typ	R mm Ø	S mm Ø	e mm Ø	H mm Ø	W mm	Y mm	Z mm	Flan-sze	Mater-iał
10-3 M 09	10	3	9,55	8,79	12,0	12,0	10,2	17,5	7,3	Z FLANSZAMI	ALUMINIUM
12-3 M 09	12	3	11,46	10,70	16,0	15,0	10,2	17,5	7,3		
14-3 M 09	14	3	13,37	12,61	18,0	18,0	10,2	17,5	7,3		
15-3 M 09	15	3	14,32	13,56	16,0	18,0	10,2	17,5	7,3		
16-3 M 09	16	1	15,28	14,52	20,0	10,0	12,8	20,6	7,8		
18-3 M 09	18	1	17,19	16,43	20,0	11,0	12,8	20,6	7,8		
20-3 M 09	20	1	19,10	18,34	23,0	13,0	12,8	20,6	7,8		
21-3 M 09	21	1	20,05	19,29	24,0	14,0	12,8	20,6	7,8		
22-3 M 09	22	1	21,01	20,25	25,0	14,0	12,8	20,6	7,8		
24-3 M 09	24	1	22,92	22,16	27,0	14,0	12,8	20,6	7,8		
26-3 M 09	26	1	24,83	24,07	27,0	16,0	12,8	20,6	7,8		
28-3 M 09	28	1	26,74	25,98	30,0	18,0	12,8	20,6	7,8		
30-3 M 09	30	1	28,65	27,89	33,0	20,0	12,8	20,6	7,8		
32-3 M 09	32	1	30,56	29,80	33,0	22,0	12,8	20,6	7,8		
36-3 M 09	36	1	34,38	33,62	40,0	26,0	13,4	22,2	8,8		
40-3 M 09	40	1	38,20	37,44	46,0	28,0	13,4	22,2	8,8		
44-3 M 09	44	1	42,02	41,26	46,0	33,0	13,4	22,2	8,8		
48-3 M 09	48	7	45,84	45,08	-	33,0	13,4	22,2	8,8		
60-3 M 09	60	7	57,30	56,54	-	33,0	13,4	22,2	8,8		
72-3 M 09	72	7	68,75	67,99	-	33,0	13,4	22,2	8,8		

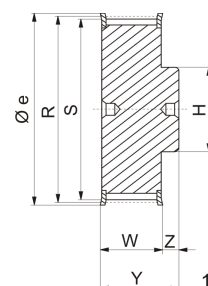

...3 M 15

Kod	Ilość zębów	typ	R mm Ø	S mm Ø	e mm Ø	H mm Ø	W mm	Y mm	Z mm	Flan-sze	Mater-iał
10-3 M 15	10	3	9,55	8,79	12,0	12,0	17,0	17,5	9	Z FLANSZAMI	ALUMINIUM
12-3 M 15	12	3	11,46	10,70	16,0	15,0	17,0	17,5	9		
14-3 M 15	14	3	13,37	12,61	18,0	18,0	17,0	17,5	9		
15-3 M 15	15	3	14,32	13,56	16,0	18,0	17,0	17,5	9		
16-3 M 15	16	1	15,28	14,52	20,0	10,0	19,5	20,6	6,5		
18-3 M 15	18	1	17,19	16,43	20,0	11,0	19,5	20,6	6,5		
20-3 M 15	20	1	19,10	18,34	23,0	13,0	19,5	20,6	6,5		
21-3 M 15	21	1	20,05	19,29	24,0	14,0	19,5	20,6	6,5		
22-3 M 15	22	1	21,01	20,25	25,0	14,0	19,5	20,6	6,5		
24-3 M 15	24	1	22,92	22,16	27,0	14,0	19,5	20,6	6,5		
26-3 M 15	26	1	24,83	24,07	27,0	16,0	19,5	20,6	6,5		
28-3 M 15	28	1	26,74	25,98	30,0	18,0	19,5	20,6	6,5		
30-3 M 15	30	1	28,65	27,89	33,0	20,0	19,5	20,6	6,5		
32-3 M 15	32	1	30,56	29,80	33,0	22,0	19,5	20,6	6,5		
36-3 M 15	36	1	34,38	33,62	40,0	26,0	20,0	22,2	10		
40-3 M 15	40	1	38,20	37,44	46,0	28,0	20,0	22,2	10		
44-3 M 15	44	1	42,02	41,26	46,0	33,0	20,0	22,2	10		
48-3 M 15	48	7	45,84	45,08	-	33,0	20,0	22,2	10		
60-3 M 15	60	7	57,30	56,54	-	33,0	20,0	22,2	10		
72-3 M 15	72	7	68,75	67,99	-	33,0	20,0	22,2	10		

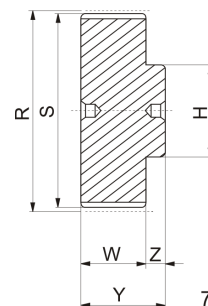
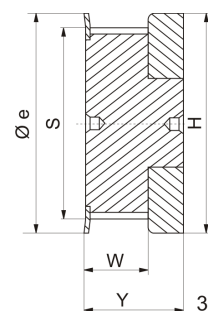

Podziałka 5 mm
...5 M 09

Kod	Ilość zębów	typ	R mm Ø	S mm Ø	e mm Ø	U mm	W mm	H mm Ø	Y mm	Z mm	Flan-sze	Mat-erial
12-5 M 09	12	1	19,10	17,96	23	-	14,5	13,0	20,0	5,5	Z FLANSZAMI	STAL
14-5 M 09	14	1	22,28	21,14	24	-	14,5	14,0	20,0	5,5		
15-5 M 09	15	1	23,87	22,73	27	-	14,5	16,0	20,0	5,5		
16-5 M 09	16	1	25,47	24,32	27	-	14,5	16,5	20,0	5,5		
18-5 M 09	18	1	28,65	27,51	30	-	14,5	20,0	20,0	5,5		
20-5 M 09	20	1	31,83	30,69	33	-	14,5	23,0	22,5	8,0		
21-5 M 09	21	1	33,42	32,28	36	-	14,5	24,0	22,5	8,0		
22-5 M 09	22	1	35,01	33,87	36	-	14,5	25,0	22,5	8,0		
24-5 M 09	24	1	38,19	37,06	40	-	14,5	27,0	22,5	8,0		
26-5 M 09	26	1	41,38	40,24	46	-	14,5	30,0	22,5	8,0		
28-5 M 09	28	1	44,56	43,42	50	-	14,5	30,5	22,5	8,0		
30-5 M 09	30	1	47,75	46,61	50	-	14,5	35,0	22,5	8,0		
32-5 M 09	32	1	50,93	49,79	55	-	14,5	38,0	22,5	8,0		
36-5 M 09	36	1	57,30	56,16	62	-	14,5	38,0	22,5	8,0		
40-5 M 09	40	1	63,66	62,52	67	-	14,5	38,0	22,5	8,0		
44-5 M 09	44	7	70,03	68,89	-	-	14,5	38,0	22,5	11,0		
48-5 M 09	48	7	76,39	75,25	-	-	14,5	45,0	22,5	11,0		
60-5 M 09	60	7	95,49	94,35	-	-	14,5	45,0	22,5	11,0		
72-5 M 09	72	3	114,59	113,45	-	90	14,5	45,0	25,5	11,0	BEZ FLANSZ	ALUMI-NIUM

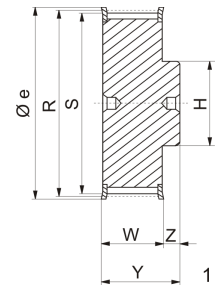

...5 M 15

Kod	Ilość zębów	typ	R mm Ø	S mm Ø	e mm Ø	U mm	W mm	H mm Ø	Y mm	Z mm	Flan-sze	Mat-erial
12-5 M 15	12	1	19,10	17,96	23	-	20,5	13,0	26,0	5,5	Z FLANSZAMI	STAL
14-5 M 15	14	1	22,28	21,14	24	-	20,5	14,0	26,0	5,5		
15-5 M 15	15	1	23,87	22,73	27	-	20,5	16,0	26,0	5,5		
16-5 M 15	16	1	25,47	24,32	27	-	20,5	16,5	26,0	5,5		
18-5 M 15	18	1	28,65	27,51	30	-	20,5	20,0	26,0	5,5		
20-5 M 15	20	1	31,83	30,69	33	-	20,5	23,0	26,0	5,5		
21-5 M 15	21	1	33,42	32,28	36	-	20,5	24,0	26,0	5,5		
22-5 M 15	22	1	35,01	33,87	36	-	20,5	25,5	26,0	5,5		
24-5 M 15	24	1	38,19	37,06	40	-	20,5	27,0	28,0	7,5		
26-5 M 15	26	1	41,38	40,24	46	-	20,5	30,0	28,0	7,5		
28-5 M 15	28	1	44,56	43,42	50	-	20,5	30,5	28,0	7,5		
30-5 M 15	30	1	47,75	46,61	50	-	20,5	35,0	28,0	7,5		
32-5 M 15	32	1	50,93	49,79	55	-	20,5	38,0	28,0	7,5		
36-5 M 15	36	1	57,30	56,16	62	-	20,5	38,0	28,0	7,5		
40-5 M 15	40	1	63,66	62,52	67	-	20,5	38,0	28,0	7,5		
44-5 M 15	44	7	70,03	68,89	-	-	20,5	38,0	30,0	9,5		
48-5 M 15	48	7	76,39	75,25	-	-	20,5	38,0	30,0	9,5		
60-5 M 15	60	7	95,49	94,35	-	-	20,5	50,0	30,0	9,5		
72-5 M 15	72	3	114,59	113,45	-	90	20,5	50,0	30,0	9,5	BEZ FLANSZ	ALUMI-NIUM

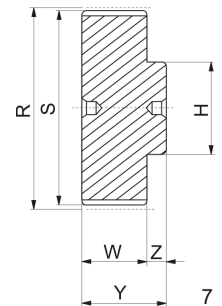

...5 M 25

Kod	Ilość zębów	typ	R mm Ø	S mm Ø	e mm Ø	U mm	W mm	H mm Ø	Y mm	Z mm	Flan-sze	Mat-erial
12-5 M 25	12	1	19,10	17,96	23	-	30,0	13,0	36,0	6	Z FLANSZAMI	STAL
14-5 M 25	14	1	22,28	21,14	24	-	30,0	14,0	36,0	6		
15-5 M 25	15	1	23,87	22,73	27	-	30,0	16,0	36,0	6		
16-5 M 25	16	1	25,47	24,32	27	-	30,0	16,5	36,0	6		
18-5 M 25	18	1	28,65	27,51	30	-	30,0	20,0	36,0	6		
20-5 M 25	20	1	31,83	30,69	33	-	30,0	23,0	36,0	6		
21-5 M 25	21	1	33,42	32,28	36	-	30,0	24,0	38,0	8		
22-5 M 25	22	1	35,01	33,87	36	-	30,0	25,5	38,0	8		
24-5 M 25	24	1	38,19	37,06	40	-	30,0	27,0	38,0	8		
26-5 M 25	26	1	41,38	40,24	46	-	30,0	30,0	38,0	8		
28-5 M 25	28	1	44,56	43,42	50	-	30,0	30,5	38,0	8		
30-5 M 25	30	1	47,75	46,61	50	-	30,0	35,0	38,0	8		
32-5 M 25	32	1	50,93	49,79	55	-	30,0	38,0	38,0	8		
36-5 M 25	36	1	57,30	56,16	62	-	30,0	38,0	38,0	8		
40-5 M 25	40	1	63,66	62,52	67	-	30,0	38,0	38,0	8		
44-5 M 25	44	7	70,03	68,89	-	-	30,0	38,0	40,0	10		
48-5 M 25	48	7	76,39	75,25	-	-	30,0	38,0	40,0	10		
60-5 M 25	60	7	95,49	94,35	-	-	30,0	50,0	40,0	10		
72-5 M 25	72	3	114,59	113,45	-	90	30,0	50,0	40,0	10	BEZ FLANSZ	ALUMI-NIUM

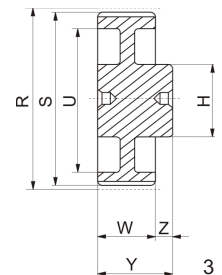

Podziałka 8 mm
...8 M 20

Kod	Ilość zębów	typ	R mm Ø	S mm Ø	e mm Ø	U mm	W mm	H mm Ø	Y mm	Z mm	d mm Ø	Flan-sze	Mater-ial
18 - 8 M 20	18	1	45,84	44,46	50	-	28	32	38	10	-	Z FLANSZAMI	STAL
20 - 8 M 20	20	1	50,93	49,56	55	-	28	36	38	10	-		
22 - 8 M 20	22	1	56,02	54,65	62	-	28	43	38	10	-		
24 - 8 M 20	24	1	61,12	59,74	67	-	28	49	38	10	-		
26 - 8 M 20	26	1	66,21	64,84	73	-	28	50	38	10	-		
28 - 8 M 20	28	1	71,30	69,93	77	-	28	55	38	10	-		
30 - 8 M 20	30	1	76,39	75,02	84	-	28	60	38	10	-		
32 - 8 M 20	32	1	81,49	80,12	88	-	28	64	38	10	-		
34 - 8 M 20	34	1	86,58	85,21	94	-	28	70	38	10	-		
36 - 8 M 20	36	1	91,67	90,30	98	-	28	75	38	10	-		
38 - 8 M 20	38	1	96,77	95,39	104	-	28	80	38	10	-		
40 - 8 M 20	40	1	101,86	100,49	108	-	28	85	38	10	-		
44 - 8 M 20	44	1	112,05	110,67	121	-	28	96	38	10	-		
48 - 8 M 20	48	1	122,23	120,86	129	-	28	104	38	10	-		
56 - 8 M 20	56	2	142,60	141,23	149	117	28	80	38	10	-		
60 - 8 M 20	60	2	152,79	151,42	158	127	28	80	38	10	-		
64 - 8 M 20	64	2	162,97	161,60	168	137	28	80	38	10	-		
72 - 8 M 20	72	2	183,35	181,97	191	158	28	80	38	10	-		
80 - 8 M 20	80	6	203,72	202,35	-	179	28	90	38	10	-		
84 - 8 M 20	84	6	213,90	212,53	-	190	28	90	38	10	-		
90 - 8 M 20	90	6	229,18	227,81	-	204	28	90	38	10	-		
112 - 8 M 20	112	5	285,21	283,83	-	260	28	90	38	10	19		
144 - 8 M 20	144	5	366,69	365,32	-	342	28	90	38	10	19		
168 - 8 M 20	168	5	427,80	426,42	-	403	28	100	38	10	19		
192 - 8 M 20	192	5	488,92	487,54	-	465	28	100	38	10	19		

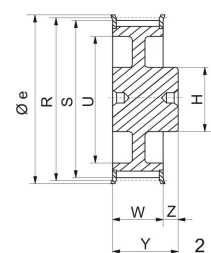
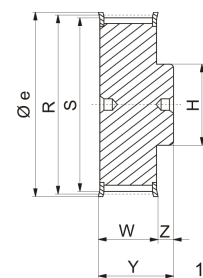

...8 M 30

Kod	Ilość zębów	typ	R mm Ø	S mm Ø	e mm Ø	U mm	W mm	H mm Ø	Y mm	Z mm	d mm Ø	Flan-sze	Mater-ial
18 - 8 M 30	18	1	45,84	44,46	50	-	38	32	48	10	-	Z FLANSZAMI	STAL
20 - 8 M 30	20	1	50,93	49,56	55	-	38	36	48	10	-		
22 - 8 M 30	22	1	56,02	54,65	62	-	38	43	48	10	-		
24 - 8 M 30	24	1	61,12	59,74	67	-	38	49	48	10	-		
26 - 8 M 30	26	1	66,21	64,84	73	-	38	50	48	10	-		
28 - 8 M 30	28	1	71,30	69,93	77	-	38	55	48	10	-		
30 - 8 M 30	30	1	76,39	75,02	84	-	38	60	48	10	-		
32 - 8 M 30	32	1	81,49	80,12	88	-	38	64	48	10	-		
34 - 8 M 30	34	1	86,58	85,21	94	-	38	70	48	10	-		
36 - 8 M 30	36	1	91,67	90,30	98	-	38	75	48	10	-		
38 - 8 M 30	38	1	96,77	95,39	104	-	38	80	48	10	-		
40 - 8 M 30	40	1	101,86	100,49	108	-	38	85	48	10	-		
44 - 8 M 30	44	1	112,05	110,67	121	-	38	96	48	10	-		
48 - 8 M 30	48	1	122,23	120,86	129	-	38	104	48	10	-		
56 - 8 M 30	56	2	142,60	141,23	149	117	38	80	48	10	-		
60 - 8 M 30	60	2	152,79	151,42	158	127	38	80	48	10	-		
64 - 8 M 30	64	2	162,97	161,60	168	137	38	80	48	10	-		
72 - 8 M 30	72	2	183,35	181,97	191	158	38	80	48	10	-		
80 - 8 M 30	80	6	203,72	202,35	-	179	38	90	48	10	-		
84 - 8 M 30	84	6	213,90	212,53	-	190	38	90	48	10	-		
90 - 8 M 30	90	6	229,18	227,81	-	204	38	90	48	10	-		
112 - 8 M 30	112	5	285,21	283,83	-	260	38	90	48	10	19		
144 - 8 M 30	144	5	366,69	365,32	-	342	38	90	48	10	19		
168 - 8 M 30	168	5	427,80	426,42	-	403	38	100	48	10	19		
192 - 8 M 30	192	5	488,92	487,54	-	465	38	100	48	10	19		

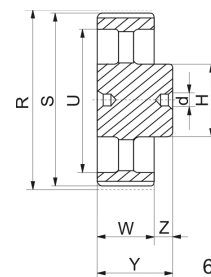
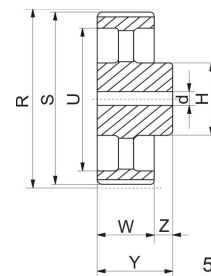

...8 M 50

Kod	Ilość zębów	typ	R mm Ø	S mm Ø	e mm Ø	U mm	W mm	H mm Ø	Y mm	Z mm	d mm Ø	Flan-sze	Mater-iał
18 - 8 M 50	18	1	45,84	44,46	50	-	60	32	70	10	-	Z FLANSZAMI	STAL
20 - 8 M 50	20	1	50,93	49,56	55	-	60	36	70	10	-		
22 - 8 M 50	22	1	56,02	54,65	62	-	60	43	70	10	-		
24 - 8 M 50	24	1	61,12	59,74	67	-	60	49	70	10	-		
26 - 8 M 50	26	1	66,21	64,84	73	-	60	50	70	10	-		
28 - 8 M 50	28	1	71,30	69,93	77	-	60	55	70	10	-		
30 - 8 M 50	30	1	76,39	75,02	84	-	60	60	70	10	-		
32 - 8 M 50	32	1	81,49	80,12	88	-	60	64	70	10	-		
34 - 8 M 50	34	1	86,58	85,21	94	-	60	70	70	10	-		
36 - 8 M 50	36	1	91,67	90,30	98	-	60	75	70	10	-		
38 - 8 M 50	38	1	96,77	95,39	104	-	60	80	70	10	-		
40 - 8 M 50	40	1	101,86	100,49	108	-	60	85	70	10	-		
44 - 8 M 50	44	1	112,05	110,67	121	-	60	96	70	10	-		
48 - 8 M 50	48	1	122,23	120,86	129	-	60	104	70	10	-		
56 - 8 M 50	56	8	142,60	141,23	149	117	60	90	60	-	-	BEZ FLANSZ	ŻELIWO
60 - 8 M 50	60	8	152,79	151,42	158	127	60	100	60	-	-		
64 - 8 M 50	64	8	162,97	161,60	168	137	60	100	60	-	-		
72 - 8 M 50	72	8	183,35	181,97	191	158	60	100	60	-	-		
80 - 8 M 50	80	9	203,72	202,35	-	179	60	110	60	-	-		
84 - 8 M 50	84	10	213,90	212,53	-	190	60	110	60	-	-		
90 - 8 M 50	90	10	229,18	227,81	-	204	60	110	60	-	-		
112 - 8 M 50	112	11	285,21	283,83	-	260	60	110	60	-	19		
144 - 8 M 50	144	11	366,69	365,32	-	342	60	110	60	-	19		
168 - 8 M 50	168	11	427,80	426,42	-	403	60	120	60	-	19		
192 - 8 M 50	192	11	488,92	487,54	-	465	60	130	60	-	19		

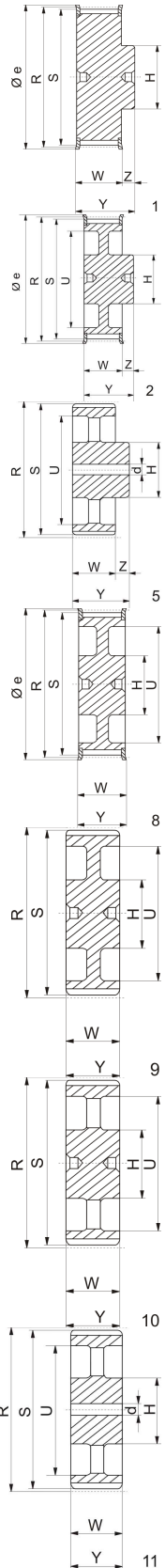

...8 M 85

Kod	Ilość zębów	typ	R mm Ø	S mm Ø	e mm Ø	U mm	W mm	H mm Ø	Y mm	Z mm	d mm Ø	Flan-sze	Mater-iał
22 - 8 M 85	22	1	56,02	54,65	62	-	95	43	105	10	-	Z FLANSZAMI	STAL
24 - 8 M 85	24	1	61,12	59,74	67	-	95	49	105	10	-		
26 - 8 M 85	26	1	66,21	64,84	73	-	95	50	105	10	-		
28 - 8 M 85	28	1	71,30	69,93	77	-	95	55	105	10	-		
30 - 8 M 85	30	1	76,39	75,02	84	-	95	60	105	10	-		
32 - 8 M 85	32	1	81,49	80,12	88	-	95	64	105	10	-		
34 - 8 M 85	34	1	86,58	85,21	94	-	95	70	105	10	-		
36 - 8 M 85	36	1	91,67	90,30	98	-	95	75	105	10	-		
38 - 8 M 85	38	1	96,77	95,39	104	-	95	80	105	10	-		
40 - 8 M 85	40	1	101,86	100,49	108	-	95	85	105	10	-		
44 - 8 M 85	44	1	112,05	110,67	121	-	95	96	105	10	-		
48 - 8 M 85	48	1	122,23	120,86	129	-	95	104	105	10	-		
56 - 8 M 85	56	1	142,60	141,23	149	-	95	107	105	10	-		
60 - 8 M 85	60	1	152,79	151,42	158	-	95	132	105	10	-		
64 - 8 M 85	64	8	162,97	161,60	168	137	95	100	95	-	-	BEZ FLANSZ	ŻELIWO
72 - 8 M 85	72	8	183,35	181,97	191	158	95	110	95	-	-		
80 - 8 M 85	80	9	203,72	202,35	-	179	95	110	95	-	-		
84 - 8 M 85	84	9	213,90	212,53	-	190	95	110	95	-	-		
90 - 8 M 85	90	10	229,18	227,81	-	204	95	110	95	-	-		
112 - 8 M 85	112	11	285,21	283,83	-	260	95	110	95	-	19		
144 - 8 M 85	144	11	366,69	365,32	-	342	95	120	95	-	19		
168 - 8 M 85	168	11	427,80	426,42	-	403	95	120	95	-	19		
192 - 8 M 85	192	11	488,92	487,54	-	465	95	130	95	-	19		

Podziałka 14 mm

...14 M 40

Kod	Ilość zębów	typ	R mm Ø	S mm Ø	e mm Ø	U mm	W mm	H mm Ø	Y mm	Z mm	d mm Ø	Flan-sze	Mater-iał
28 - 14 M 40	28	1	124,78	122,12	134	-	54	100	69	15	-	Z FLANSZAMI	ŻELIWO
29 - 14 M 40	29	1	129,23	126,57	134	-	54	107	69	15	-		
30 - 14 M 40	30	1	133,69	130,99	142	-	54	107	69	15	-		
32 - 14 M 40	32	1	142,60	139,88	150	-	54	114	69	15	-		
34 - 14 M 40	34	1	151,51	148,79	158	-	54	122	69	15	-		
36 - 14 M 40	36	1	160,43	157,68	166	-	54	128	69	15	-		
38 - 14 M 40	38	1	169,34	166,60	177	-	54	141	69	15	-		
40 - 14 M 40	40	1	178,25	175,49	186	-	54	148	69	15	-		
44 - 14 M 40	44	2	196,08	193,28	209	154	54	120	69	15	-		
48 - 14 M 40	48	2	213,90	211,11	216	172	54	135	69	15	-		
56 - 14 M 40	56	2	249,56	246,76	261	207	54	135	69	15	-		
60 - 14 M 40	60	2	267,38	264,59	274	225	54	135	69	15	-		
64 - 14 M 40	64	2	285,21	282,41	288	243	54	135	69	15	-		
72 - 14 M 40	72	5	320,86	318,06	-	279	54	135	69	15	19	BEZ FLANSZ	ŻELIWO
80 - 14 M 40	80	5	356,51	353,71	-	314	54	135	69	15	19		
84 - 14 M 40	84	5	374,33	371,54	-	332	54	135	69	15	19		
90 - 14 M 40	90	5	401,07	398,28	-	359	54	135	69	15	19		
112 - 14 M 40	112	5	499,11	496,32	-	457	54	135	69	15	19		
144 - 14 M 40	144	5	641,71	638,92	-	600	54	135	69	15	19		

...14 M 55

Kod	Ilość zębów	typ	R mm Ø	S mm Ø	e mm Ø	U mm	W mm	H mm Ø	Y mm	Z mm	d mm Ø	Flan-sze	Mater-ial
28 - 14 M 55	28	1	124,78	122,12	134	-	70	100	85	15	-	Z FLANSZAMI	ZELIWO
29 - 14 M 55	29	1	129,23	126,57	134	-	70	107	85	15	-		
30 - 14 M 55	30	1	133,69	130,99	142	-	70	107	85	15	-		
32 - 14 M 55	32	1	142,60	139,88	150	-	70	114	85	15	-		
34 - 14 M 55	34	1	151,51	148,79	158	-	70	122	85	15	-		
36 - 14 M 55	36	1	160,43	157,68	166	-	70	128	85	15	-		
38 - 14 M 55	38	1	169,34	166,60	177	-	70	141	85	15	-		
40 - 14 M 55	40	1	178,25	175,49	186	-	70	148	85	15	-		
44 - 14 M 55	44	2	196,08	193,28	209	154	70	120	85	15	-		
48 - 14 M 55	48	8	213,90	211,11	216	172	70	135	70	-	-		
56 - 14 M 55	56	8	249,56	246,76	261	207	70	135	70	-	-		
60 - 14 M 55	60	8	267,38	264,59	274	225	70	135	70	-	-		
64 - 14 M 55	64	8	285,21	282,41	288	243	70	135	70	-	-		
72 - 14 M 55	72	11	320,86	318,06	-	279	70	135	70	-	19		
80 - 14 M 55	80	11	356,51	353,71	-	314	70	135	70	-	19		
84 - 14 M 55	84	11	374,33	371,54	-	332	70	135	70	-	19		
90 - 14 M 55	90	11	401,07	398,28	-	359	70	135	70	-	19		
112 - 14 M 55	112	11	499,11	496,32	-	457	70	135	70	-	19		
144 - 14 M 55	144	11	641,71	638,92	-	600	70	135	70	-	19		
												BEZ FLANSZ	

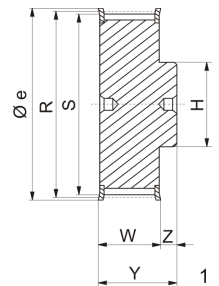

...14 M 85

Kod	Ilość zębów	typ	R mm Ø	S mm Ø	e mm Ø	U mm	W mm	H mm Ø	Y mm	Z mm	d mm Ø	Flan-sze	Mater-ial
28 - 14 M 85	28	1	124,78	122,12	134	-	102	100	117	15	-	Z FLANSZAMI	ZELIWO
29 - 14 M 85	29	1	129,23	126,57	134	-	102	107	117	15	-		
30 - 14 M 85	30	1	133,69	130,99	142	-	102	107	117	15	-		
32 - 14 M 85	32	1	142,60	139,88	150	-	102	114	117	15	-		
34 - 14 M 85	34	1	151,51	148,79	158	-	102	122	117	15	-		
36 - 14 M 85	36	1	160,43	157,68	166	-	102	128	117	15	-		
38 - 14 M 85	38	1	169,34	166,60	177	-	102	141	117	15	-		
40 - 14 M 85	40	1	178,25	175,49	186	-	102	148	117	15	-		
44 - 14 M 85	44	1	196,08	193,28	209	-	102	169	117	15	-		
48 - 14 M 85	48	1	213,90	211,11	216	-	102	186	117	15	-		
56 - 14 M 85	56	8	249,56	246,76	261	207	102	150	102	-	-		
60 - 14 M 85	60	8	267,38	264,59	274	225	102	150	102	-	-		
64 - 14 M 85	64	8	285,21	282,41	288	243	102	150	102	-	-		
72 - 14 M 85	72	11	320,86	318,06	-	279	102	150	102	-	19		
80 - 14 M 85	80	11	356,51	353,71	-	314	102	150	102	-	19		
84 - 14 M 85	84	11	374,33	371,54	-	332	102	150	102	-	19		
90 - 14 M 85	90	11	401,07	398,28	-	359	102	150	102	-	19		
112 - 14 M 85	112	11	499,11	496,32	-	457	102	150	102	-	19		
144 - 14 M 85	144	11	641,71	638,92	-	600	102	150	102	-	19		
												BEZ FLANSZ	

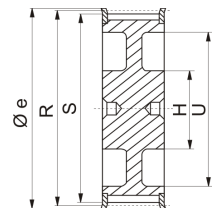
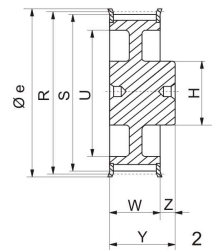

...14 M 115

Kod	Ilość zębów	typ	R mm Ø	S mm Ø	e mm Ø	U mm	W mm	H mm Ø	Y mm	Z mm	d mm Ø	Flan-sze	Mater-ial
28 - 14 M 115	28	1	124,78	122,12	134	-	133	100	148	15	-	Z FLANSZAMI	ZELIWO
29 - 14 M 115	29	1	129,23	126,57	134	-	133	107	148	15	-		
30 - 14 M 115	30	1	133,69	130,99	142	-	133	107	148	15	-		
32 - 14 M 115	32	1	142,60	139,88	150	-	133	114	148	15	-		
34 - 14 M 115	34	1	151,51	148,79	158	-	133	122	148	15	-		
36 - 14 M 115	36	1	160,43	157,68	166	-	133	128	148	15	-		
38 - 14 M 115	38	1	169,34	166,60	177	-	133	141	148	15	-		
40 - 14 M 115	40	1	178,25	175,49	186	-	133	148	148	15	-		
44 - 14 M 115	44	1	196,08	193,28	209	-	133	169	148	15	-		
48 - 14 M 115	48	1	213,90	211,11	216	-	133	186	148	15	-		
56 - 14 M 115	56	2	249,56	246,76	261	207	133	150	148	15	-		
60 - 14 M 115	60	8	267,38	264,59	274	225	133	150	133	-	-		
64 - 14 M 115	64	8	285,21	282,41	288	243	133	150	133	-	-		
72 - 14 M 115	72	11	320,86	318,06	-	279	133	150	133	-	19		
80 - 14 M 115	80	11	356,51	353,71	-	314	133	150	133	-	19		
84 - 14 M 115	84	11	374,33	371,54	-	332	133	150	133	-	19		
90 - 14 M 115	90	11	401,07	398,28	-	359	133	150	133	-	19		
112 - 14 M 115	112	11	499,11	496,32	-	457	133	150	133	-	19		
144 - 14 M 115	144	11	641,71	638,92	-	600	133	150	133	-	19		
												BEZ FLANSZ	

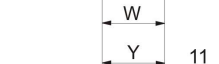
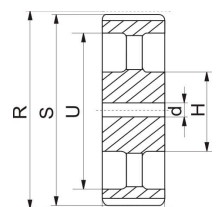

...14 M 170

Kod	Ilość zębów	typ	R mm Ø	S mm Ø	e mm Ø	U mm	W mm	H mm Ø	Y mm	Z mm	d mm Ø	Flan-sze	Mater-ial
28 - 14 M 170	28	1	124,78	122,12	134	-	187	100	202	15	-	Z FLANSZAMI	ZELIWO
29 - 14 M 170	29	1	129,23	126,57	134	-	187	107	202	15	-		
30 - 14 M 170	30	1	133,69	130,99	142	-	187	107	202	15	-		
32 - 14 M 170	32	1	142,60	139,88	150	-	187	114	202	15	-		
34 - 14 M 170	34	1	151,51	148,79	158	-	187	122	202	15	-		
36 - 14 M 170	36	1	160,43	157,68	166	-	187	128	202	15	-		
38 - 14 M 170	38	1	169,34	166,60	177	-	187	141	202	15	-		
40 - 14 M 170	40	1	178,25	175,49	186	-	187	148	202	15	-		
44 - 14 M 170	44	1	196,08	193,28	209	-	187	169	202	15	-		
48 - 14 M 170	48	1	213,90	211,11	216	-	187	186	202	15	-		
56 - 14 M 170	56	2	249,56	246,76	261	207	187	160	202	15	-		
60 - 14 M 170	60	2	267,38	264,59	274	225	187	160	202	15	-		
64 - 14 M 170	64	2	285,21	282,41	288	243	187	180	202	15	-		
72 - 14 M 170	72	12	320,86	318,06	-	279	187	180	187	-	19		
80 - 14 M 170	80	12	356,51	353,71	-	314	187	180	187	-	19		
84 - 14 M 170	84	11	374,33	371,54	-	332	187	180	187	-	19		
90 - 14 M 170	90	11	401,07	398,28	-	359	187	180	187	-	19		
112 - 14 M 170	112	11	499,11	496,32	-	457	187	200	187	-	19		
144 - 14 M 170	144	11	641,71	638,92	-	600	187	220	187	-	19		
												BEZ FLANSZ	

